Technical Specifications

San Jose Civic 

135 West San Carlos Street
San Jose, CA 95113

TABLE OF CONTENTS

Overview	3
Fast Facts	4
Stage Dimensions	4
Load In	5
Stagehands	5
Curtains, Softgoods, Masking and Miscellaneous	6
Stage Rigging & Lighting	6-10
Power	11
Sound	11
Video	11
Additional Spaces	12
House Seating Capacities	12
Pianos	12
Odds and Ends	12
Sky Bar Floor Plan	13
Civic & Montgomery Courtyard Floor Plan	14
Main Level Floor Plan	15
Main Level Reserved Seating Plan	16
Main level Banquet Seating Plan	17
Balcony Level Seating Plan	18
Second and Mezzanine Level Floor Plan	19
Other Addresses and Phone Numbers	20-21

Overview

The dual-level San Jose Civic completed a multi-million dollar renovation in 2011 enhancing the experience of this modern and historic venue. The San Jose Civic is an easy fit for a full range of events including general sessions, small meetings, evening galas, banquet dinners, cocktail receptions, performing arts and more. Patrons will enjoy new, customized fixed seating, state-of-the-art sound and HD video systems, renovated and expanded restrooms, renovated concession areas and a new 3-story elevator.

The San Jose Civic is a must-play venue for top acts touring the West Coast. With an intimate view from every seat, the San Jose Civic is an ideal location for popular entertainers and public figures.

Built in 1934, the San Jose Civic has classic Spanish mission-style architecture and has been at the core of San Jose's cultural activity and traditions. Conveniently located in the heart of Downtown, the San Jose Civic provides additional exhibit and general assembly space in conjunction with the nearby Convention Center and Parkside Hall.

The San Jose Civic is located within walking distance of hotels, bars, restaurants, museums and is directly across the street from a Light Rail station stop, making for easy public transportation access. Parking is close at the Convention Center as well as other Downtown lots.

Fast Facts

- Built in 1934 with classic Spanish mission-style architecture; a San Jose historic gem
- Hub of San Jose's cultural activity and traditions
- Dual-level layout and perfect for concerts, performances, general sessions, evening galas, banquet dinners, reunions, proms and much more
- Directly across the street from the Convention Center
- Easy access to parking, public transportation, hotels and restaurants
- Full service Box Office
- Connected to Montgomery Theater
- Large entry area perfect for cocktail receptions or registration
- Concessions areas throughout
- Flexible seating configuration, including ADA compliant seating
- Undergone \$15 million in renovations, including seating upgrades, new restrooms, new flooring and production upgrades
- Has hosted thousands of well-known entertainers and public figures including Richard Nixon, Frank Sinatra, the Rolling Stones, The Beach Boys, The Grateful Dead, Interpol, Jeff Beck, The Pixies, Wilco and many more
- Dressing Rooms throughout
- VIP areas (Sky Bar Lounges) for private cocktail/VIP receptions or breakout sessions

Stage Dimensions

· Proscenium Width	49' 9"
· Proscenium Height	30' 0"
· Grid Height	64' to beams
· CL to Stage Left Wall	45'6"
· Stage Left Wall to Stage Right Wall	120'6"
· CL to Stage Right Wall	75'
· PL to House Curtain	1' 0"
· PL to US Wall (at CL)	35'
· PL to FOH Control Room	155' 6"

Load In

The two truck loading dock is located on the north side of the building accessed off of S Market St. Down stage center there is a 3 stop (stage, floor, basement) lift with a 3000lbs capacity.

The San Jose Civic is located at 135 West San Carlos, San Jose, CA 95113. The Loading dock address is 210 S Market St

Stagehands

General Guideline of Rates and Conditions:

- Concerts and entertainment: Load In is a 4 hour minimum. Performance Call which commences 30 minutes prior to curtain and ends 3.5 hours after curtain or you shall be billed on the hour for OT. Load Out is a 4 hour minimum or 3 hours if one worked the show call.
- Lectures, corporate parties, commercial and industrial events, trade shows, computer generated presentations, as well as audio and/or video recording, where the product is to be sold to the attendees or the general public. 8 Hour minimums for everyone but loaders who have 5 hour minimums.
-
- Stagehands break for 15 minutes after 2 continuous hours worked and break for meal after 5 hours worked. Work on stage shall cease for 1 hour during non-paid one hour meal breaks. 30 minute meal breaks shall be paid and the stage hands shall have their meal provided for them by the client. Meal penalty is two times the prevailing rate. Returning from a 1 hour meal break a stagehand receives a 2 hour minimum.
- Work between the hours of Midnight and 7am shall be paid at double time.
- There shall be department heads for Sound, Electrics, Lighting, Video, and Carpentry. The steward is above the call. Standard union rules apply.

Curtains, Soft Goods, Masking and Miscellaneous

2 Black Velour Legs 14'w x 32'h

3 Black Velour Borders 60'w x 8'h, Bottom trim is 26'

1 Full Stage Traveler 60'w x 32'h, located mid stage

1 Full Upstage Black Velour Drape 60'w x 32'h

All legs and boarders are dead hung and are not moveable at all.

Main Curtain

Traveler type, Red

Stage Rigging

Stage to Rigging Steel is 63'. 12 beams in pairs with wells between each pair. First pair on Center. Wells are about 12.5' apart. 3 options for each beam:

1. As a single point load placed anywhere on the span, 2500 pounds.
2. As two point loads placed at third points along the span, each load 2000 pounds for a maximum total of 4,000 pounds. Note that this loading assumes that one load is located 12' from the north wall and the second is located 12' from the south wall.
3. As three point loads placed at quarter points along the span, each load of 1400 pounds for a maximum load of 4,200 pounds. Note that this loading assumes that each load is 9' apart and that end loads are 9' from their respective walls.

HOUSE

60' Downstage truss 14' from the downstage edge. This truss is utilized for rigging typically for traveling lighting trusses of 40' and hangs from four ½ ton motors.

There are 6 rows of circus points starting 14' from the down stage edge. Each row is 18'8" apart.

There are 6 points to a row with a 1500 lbs capacity (1000 lbs per point for first of six).

For each row of points: First points are 8' off center, Second set 23' 5" off center, Third set is 39' 11" off center.

Hang Plot from plaster line

LINE	DEPTH	TYPE	PIECE	Notes
	4'		Apron	48" DS of Plaster line
1	6"	Dead Hung (DH)	Main Valance	
2	1'	DH	MAIN DRAPE	Traveler type
3	3'	Counter Weight	BANNER BAR	
4	4'	CW		Comes in to 5' off stage floor
5	6' 6"	DH	BORDER	
6	8'	DH	LEGS	
7	9' 6"	CW	BANNER BAR	Comes in to 10' off stage floor
8	13'6"	DH	BORDER	
9	14'	Chain Motors	MS TRUSS	40'x12" box, (2) 1 ton motors
10	15'	Chain Motors	Center Traveller	Acts as mid stage legs as well
11	16'	CW	BANNER BAR	Comes in to 10' off stage floor
12	23' 6"	DH	BORDER	
13	24'	DH	LEGS	
14	26'	Chain Motors	US TRUSS	30" PRT truss (3) 1 ton motors

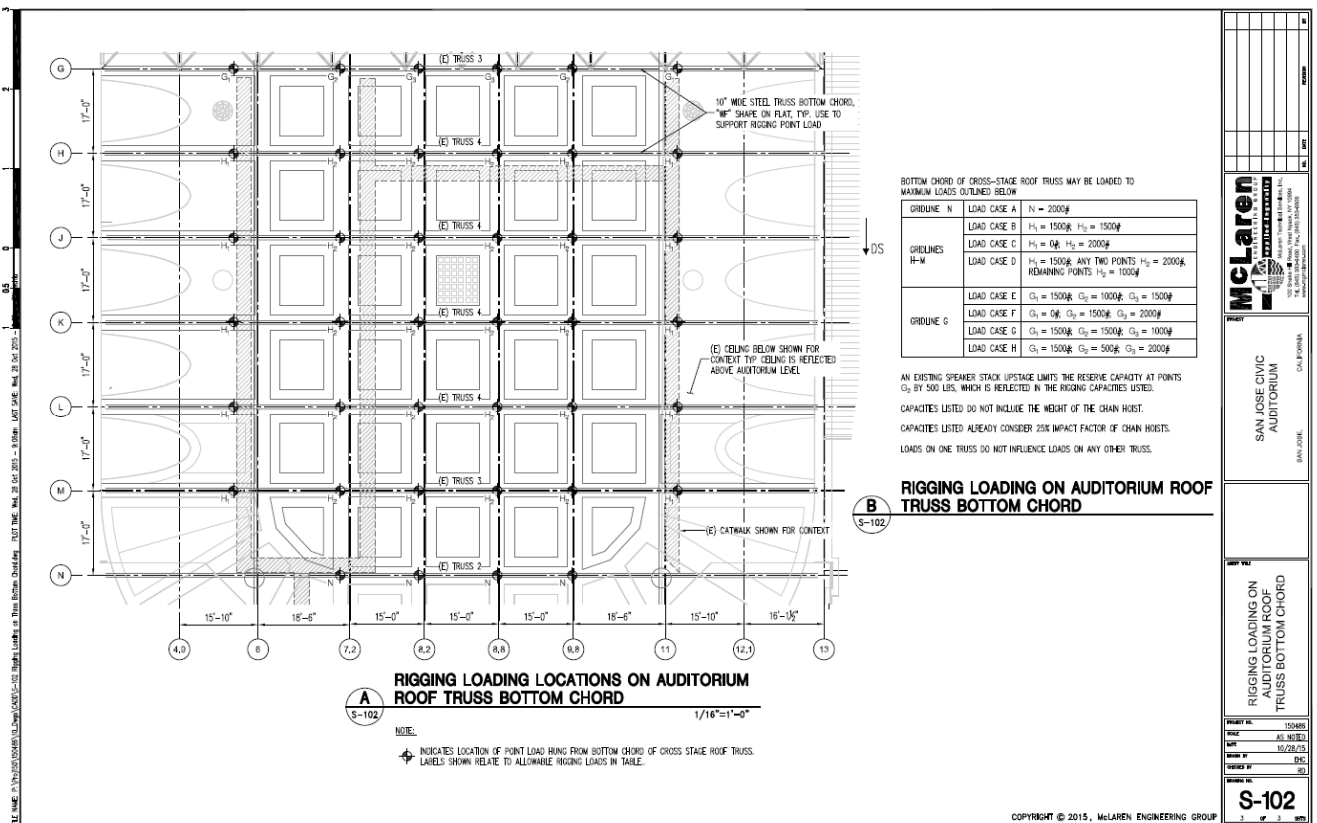
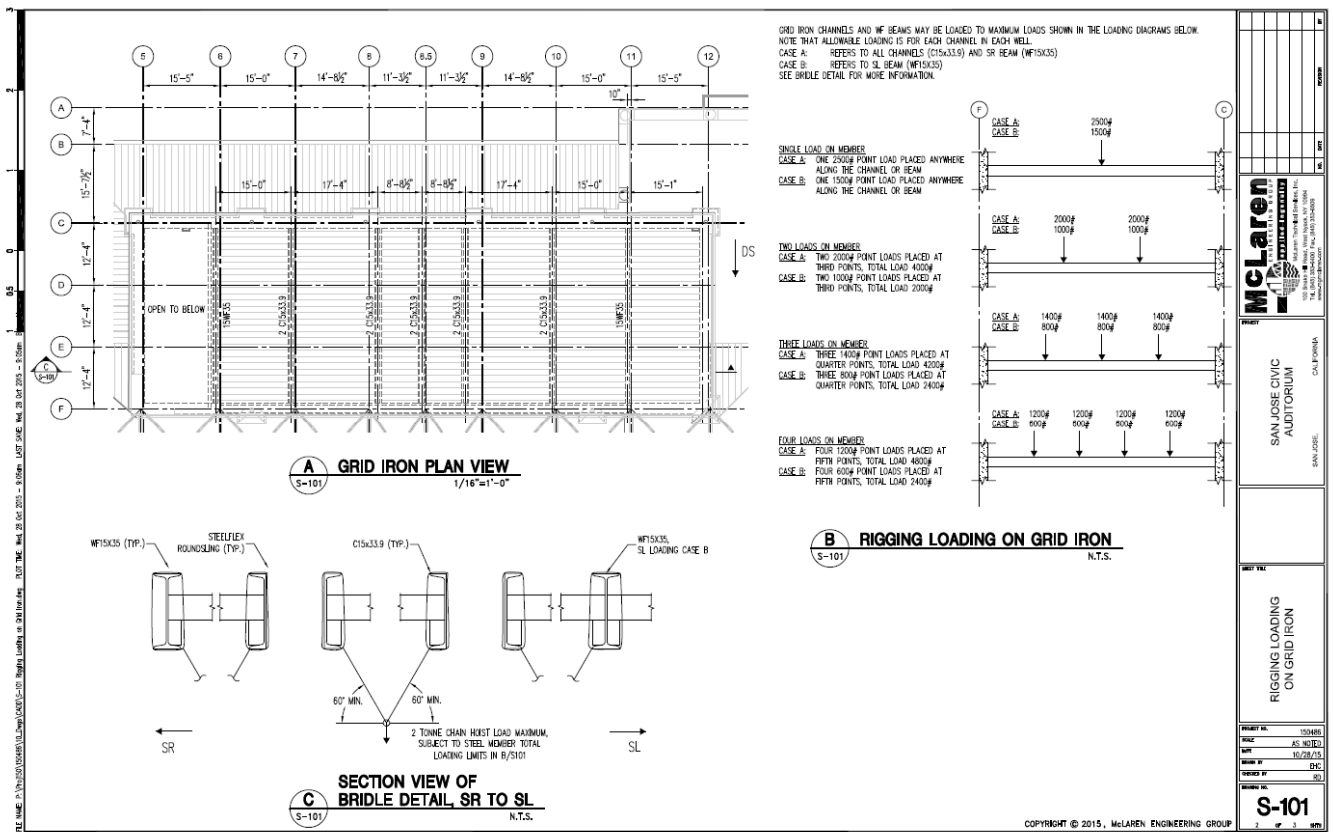

US TRUSS

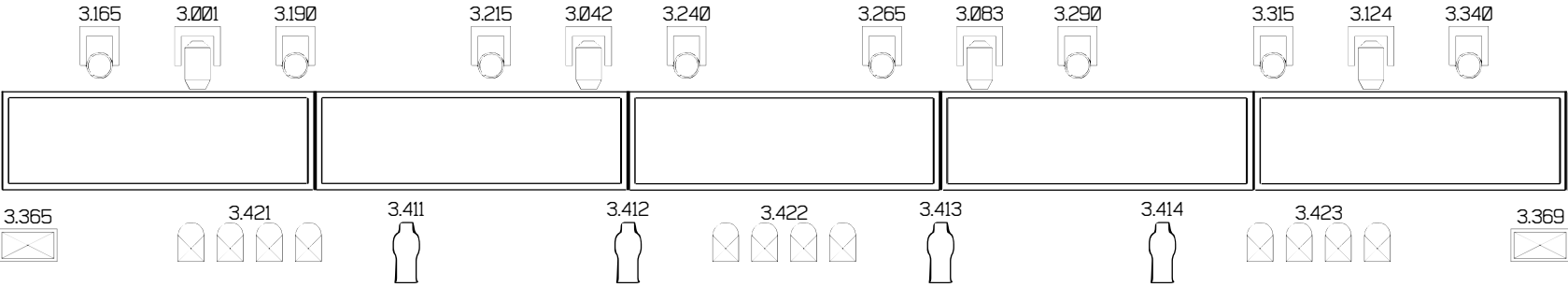

MS TRUSS

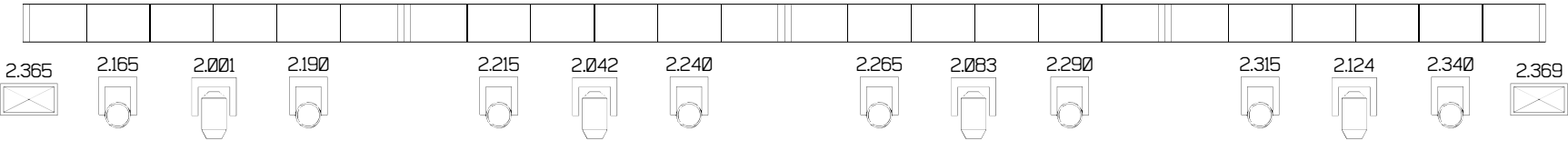

KEY



FOH LIGHTING CONTROL SNAKE

- 4 - DMX UNIVERSE 5PIN XLR - 1 SPARE
- 2 - ETHERCON - SPARE
- 1 - COM LINE 3PIN XLR
- 1 - 20AMP 120VOLT AC CIRCUIT

OPTIONAL EQUIPMENT

- 1 - GRAND MA3 LIGHT LIGHTBOARD
- 4 - 2K LYCIAN FOLLOWSPOT - 9" CF
- 1 - DF-50 HAZER (ADDRESS 3.426)

SAN JOSE CIVIC
ADDRESS NUMBER PLOT

DS TRUSS

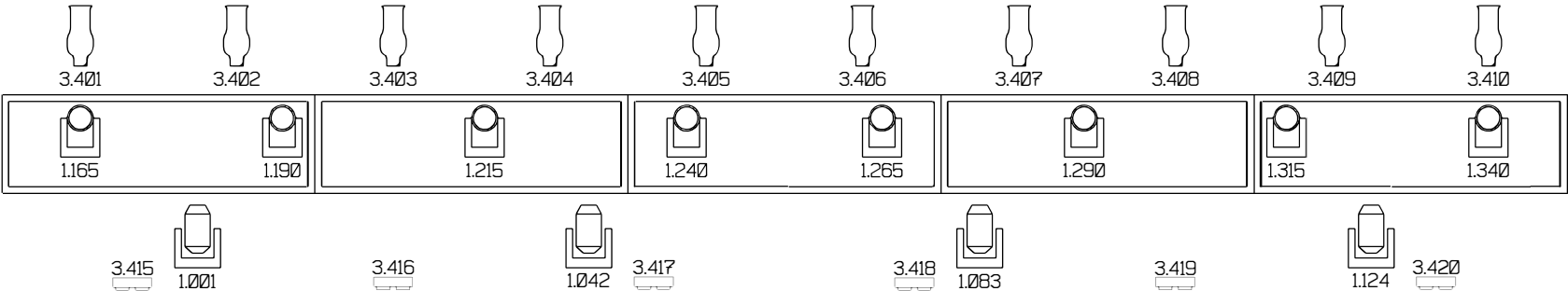

Lighting

4 – LYCIAN XL 1290 spotlights
Grand MA 3 Lite lighting console
12 – Martin ERA 600 spot Fixtures
24 – Martin Aura XB wash fixtures
12 – Source Four Lyco all 19 Degree
6 – Audience Blinders 4 Lights
5 – ACL 4-Lamp Bars
4 – Atomic 3000 Strobes
1 – Sensor 96x2.4K Dimmer
1 – FOH Snake (4 – 5 pin, 1 – 3 pin, 2 – CAT5, 1 – 120v)
1 – DF50 Hazer

Power

1200 amps 3 phase TOTAL power on stage. All cam lock or bare tails.
Lighting: 2 – 400amps 3 phase Up Stage Right.
Sound: 2 – 200amps (isolated) 3 phase Downstage Left and Right.
Lighting fed from 800 amp distro panel.
Sound is fed from an isolated 400 amp distro panel.

Sound

Yamaha CL 5 Front of House Console
18 – D&B KSL 8 Line Array (9 boxes a side)
Hung from single point each downstage of proscenium, 1450lbs max
load 6 – D&B SL-GSUB ground floor stacked across the front of the stage
4 – D&B Y10P Front Fills
2 – Lake LM44 processors
D&B amplification
2 – Yamaha Rio 3224-D2 Stage boxes
1 – Whirlwind STS-SR358 1X3 Splitter
1 – Tascam CD-RW901 Player/Recorder

4 – Shure UR2 4S Wireless (Just Handheld)
4 – Shure UR2 4d Wireless (Handheld/Bodypack Combos)
4 – Shure UR1 Wireless

4 – VP-7212-DPAN Side Fill Speakers
2 – VP7212MDP Wedge Monitor Speakers

10 – Stations of Wired ClearCom

Power Distributor has Camlock Passthrough

Snake runs are around the perimeter of the floor with 12" pull tubes under walkways house left, house right and at FOH position. 250' snake will reach to FOH

Video

2 – 16'x9', 2.9 mm Absen LED walls hung left and right of the proscenium. 1980x1020I resolution. They do not come down.

2 – Novastar MCTRL600 processors, Nov-CT-Mars v4.90 software

1 – Magnaimage Scaler

1 – Panasonic AV-HS410 HD Video Switcher

1 – Apple Mac Pro Tower with Final Cut Pro

1 – Blue Ray Player

3 – JVC Cameras GY-HD250-CSTNL with studio packages (3 standard lenses and 1 long throw)

4 – Panasonic HE-70 PTZ cameras, 2 mounted, 2 mobile

1 – 40" Samsung Floor Monitor

Additional Spaces

Dressing Rooms

All Furnished. There is no elevator to the second level. All large cases must remain on stage level.
Drawings available upon request

<u>Dressing Room</u>	<u>Dimensions</u>	<u>Amenities</u>
<i>Stage Level</i>		
Dressing Room 1	24'7" x 15'6"	Bathroom, Handicap Bathroom, Sink, Toilet, Shower, Makeup Counter, Couches, Television
Dressing Room 2	24'7" x 15'6"	Bathroom, Handicap Bathroom, Sink, Toilet, Shower, Makeup Counter, Couches, Television
<i>One Level Above Stage</i>		
Dressing Room 3	24'4" x 14'10"	Television, Couches, Sink, Makeup and Mirror Counter, Washer, Dryer
Men's Bathroom	12'9" x 7'4"	Toilet, Shower, Sink
Dressing Room 4	22'4" x 7'5"	Couches, Makeup and Mirror Counter
Dressing Room 5	14'5" x 7'5"	Sink, Makeup and Mirror Counters
Dressing Room 6	15'3" x 7'5"	Sink, Makeup and Mirror Counters
Women's Bathroom	12'9" x 7'4"	Toilet, Shower, Sink
Dressing Room 7	20'3" x 21'	Television, Couches, Table, Makeup and Mirror Counters
Dressing Room 7 1/2	24'6" x 14'	Lounge and Mirror Counter

Production Office

We usually put production in Dressing Room 1 on stage.

House Seating Capacities

2,850 maximum seating capacity, theater-style (Section 105, Rows K-S removed to accommodate maximum light and sound mixing area;

3,322 maximum GA configuration including a 20x20 mixing area and GA barricade).

- 1,028 Main Floor seating
- 628 Dress Circle seating (49 obstructed view)
- 1,194 Balcony seating (90 obstructed view)
- 350 Banquet-style event on Main Floor ONLY
- 1,000 Classroom-style event on Main Floor ONLY

Pianos

House has no piano.

Odds & Ends

Theater has a 36' genie personnel lift.

We have Shore Power for 4 Buses.

Parking in San Jose Civic Plaza can accommodate up to 10 busses.

Sky Bar

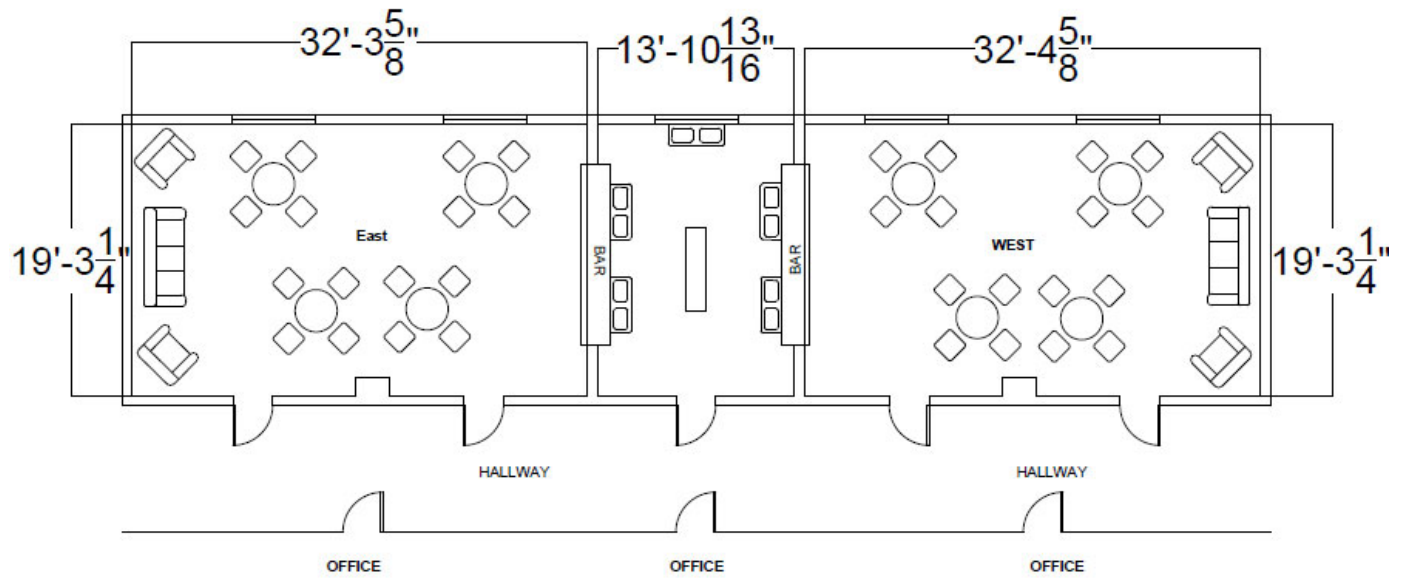

Montgomery Courtyard & Civic Courtyard

*Pricing to add the Montgomery Courtyard along with availability of the space is on a case by case basis. Please contact your Sales Manager with any questions.

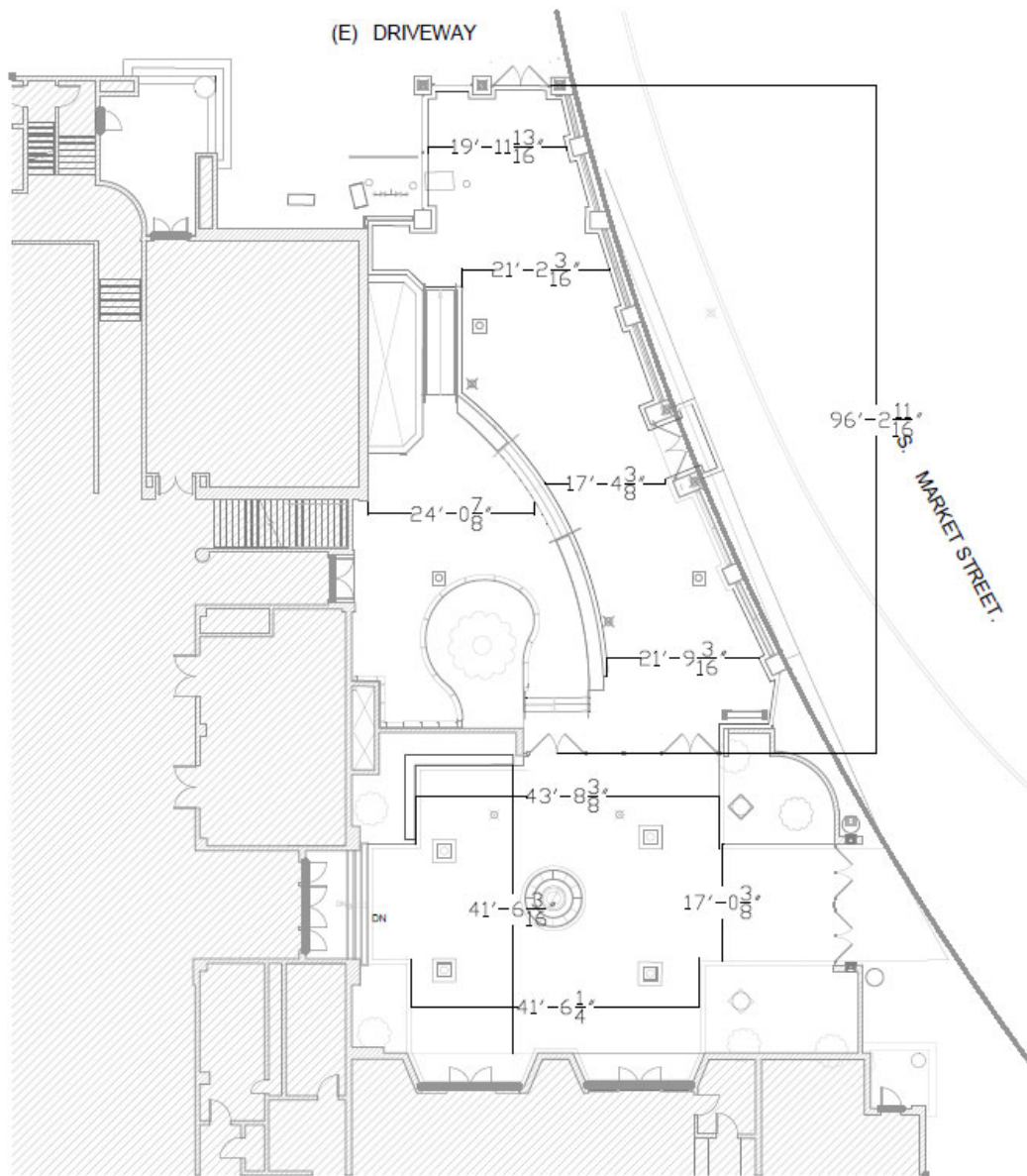

MAIN LEVEL FLOOR PLAN

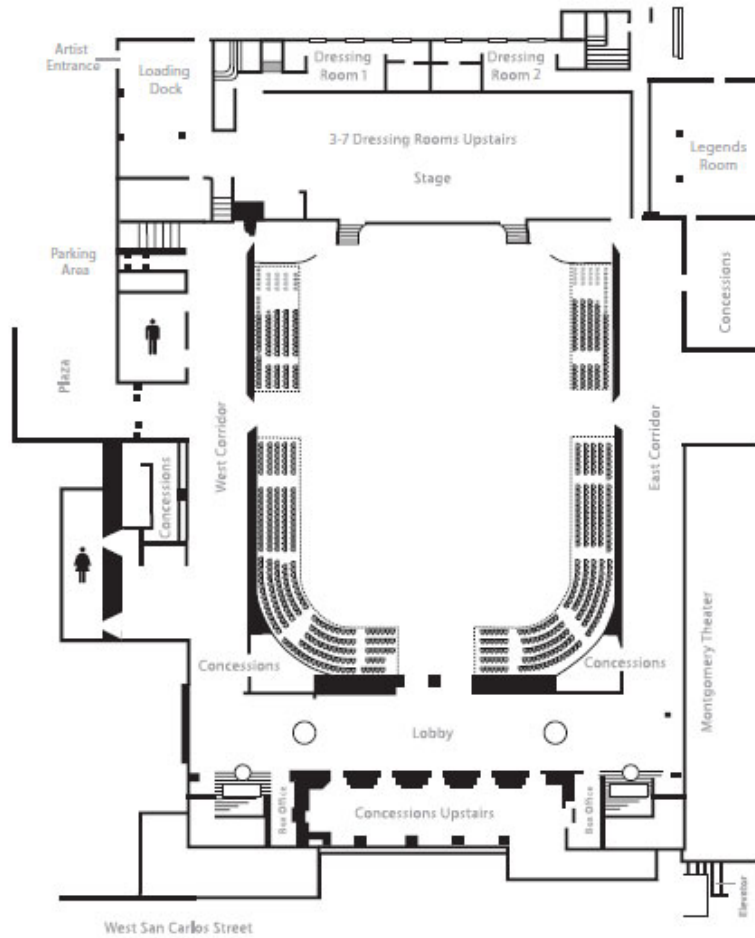

Location	Capacity	Main Level Capacity	Main Floor Section Seating Capacity	Dress Circle Section Seating Capacity	Balcony Level Seating Capacity	Stage Size (W x D)	Stage Proscenium Opening (W x H)	Main Floor Size	Ceiling
San Jose Civic	2,850 Reserved 3,322 GA	1,856 Reserved 2,128 GA	1,028 Reserved 1,500 GA	628 Total (including 52 obstructed view seats)	1,194 Total (including 90 obstructed view seats)	112' x 35'	49' 9" x 30'	79' x 118'	43'

MAIN LEVEL RESERVED CONCERT SEATING PLAN

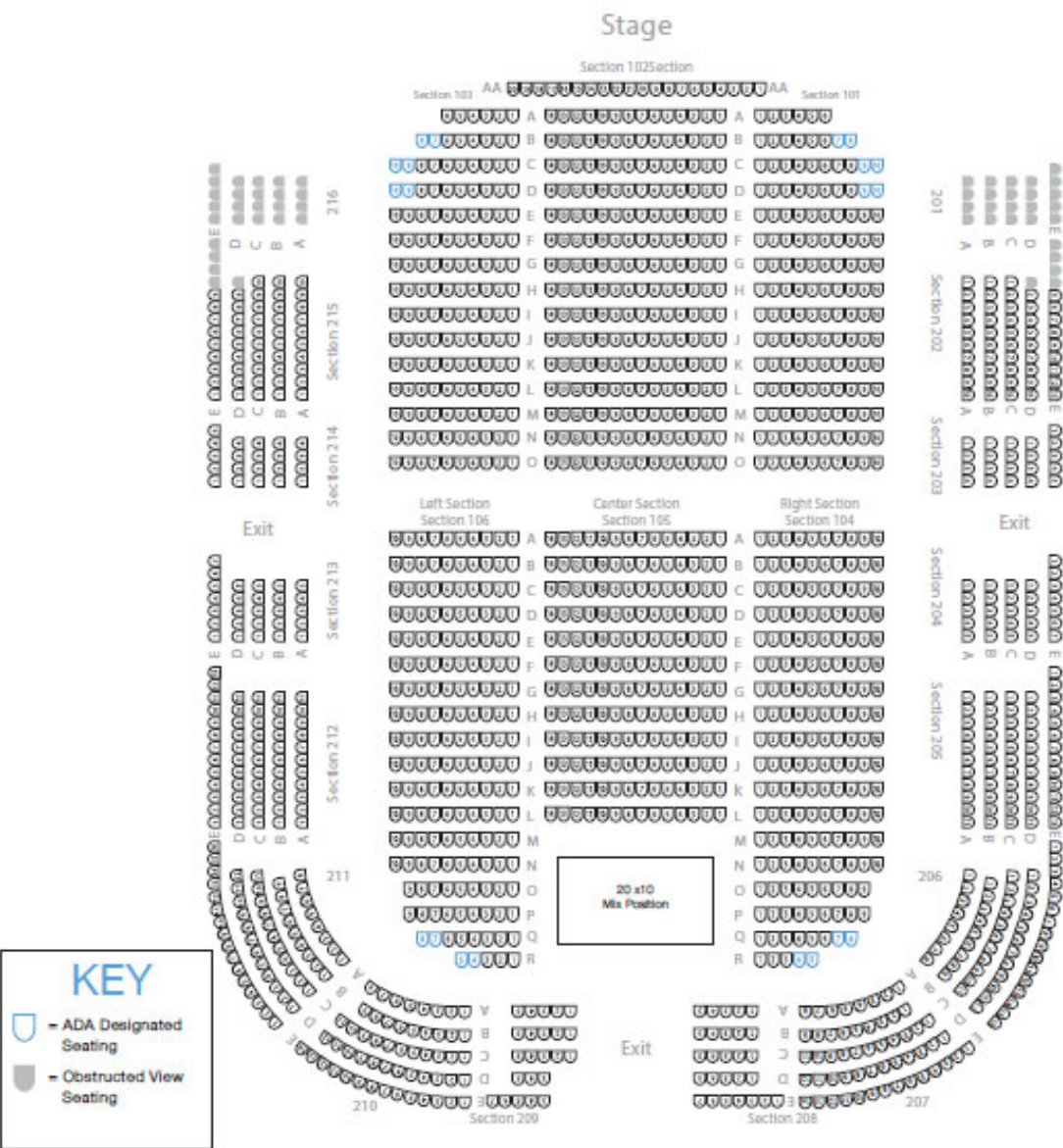

Location	Capacity	Main Level Capacity	Main Floor Section Seating Capacity	Dress Circle Section Seating Capacity	Balcony Level Seating Capacity	Stage Size (W x D)	Stage Proscenium Opening (W x H)	Main Floor Size	Ceiling
San Jose Civic	2,850 Reserved 3,322 GA	1,656 Reserved 2,128 GA	1,028 Reserved 1,500 GA	628 Total (including 52 obstructed view seats)	1,194 Total (including 90 obstructed view seats)	112' x 35'	49' 9" x 30'	79' x 118'	43'

MAIN LEVEL BANQUET SEATING PLAN

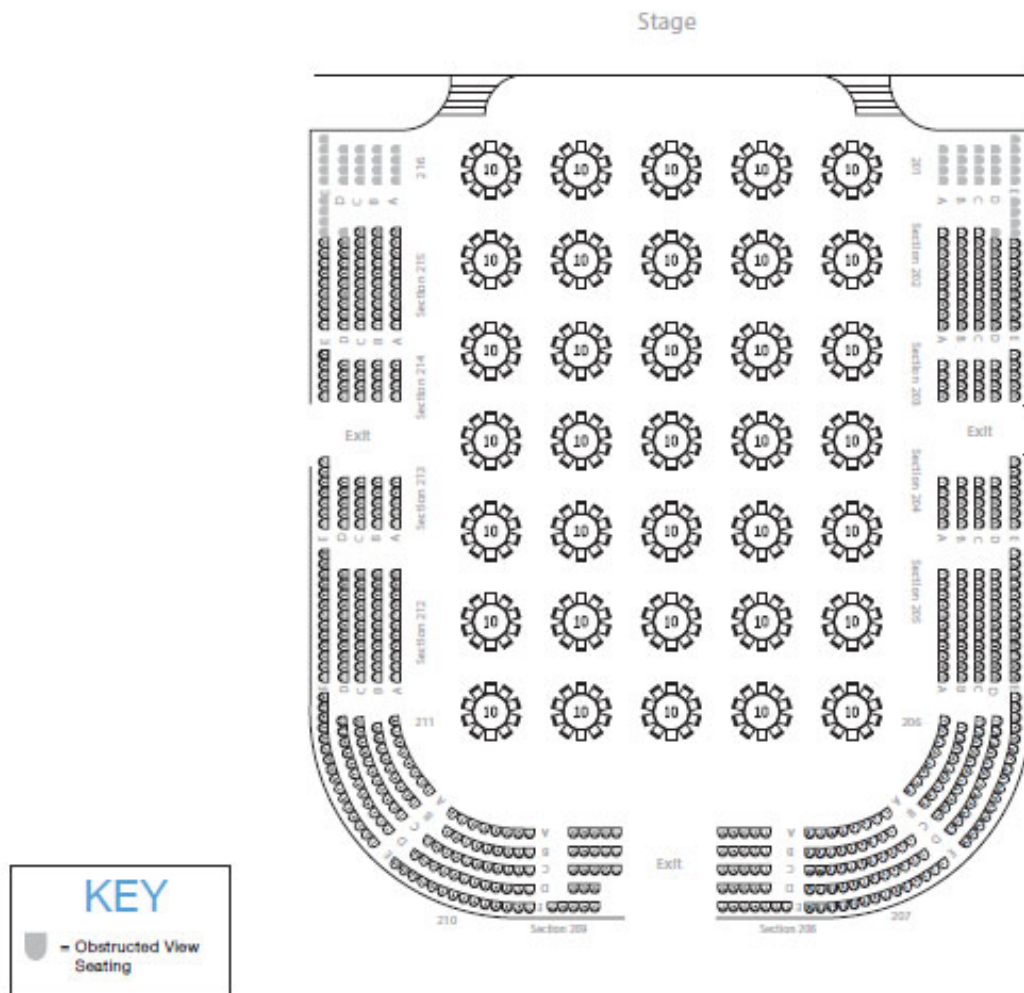

Location	Capacity	Main Level Capacity	Main Floor Section Seating Capacity	Dress Circle Section Seating Capacity	Balcony Level Seating Capacity	Stage Size (W x D)	Stage Proscenium Opening (W x H)	Main Floor Size	Ceiling
San Jose Civic	2,850 Reserved 3,322 GA	1,656 Reserved 2,128 GA	350 Banquet*	628 Total (including 52 obstructed view seats)	1,194 Total (including 90 obstructed view seats)	112' x 35'	49' 9" x 30'	79' x 118'	43'

*Seating setup and capacity subject to change

BALCONY LEVEL SEATING PLAN

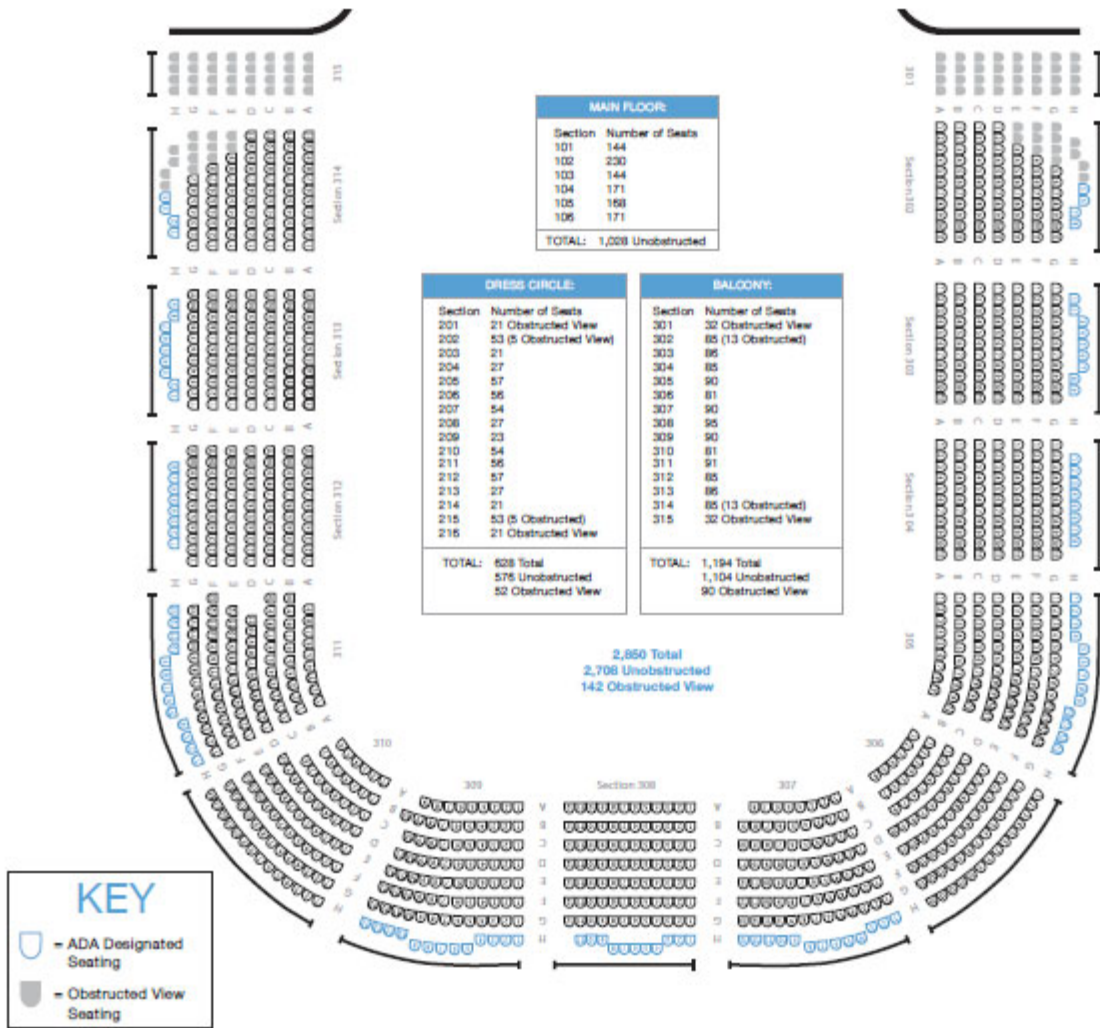

Location	Capacity	Main Level Capacity	Main Floor Section Seating Capacity	Dress Circle Section Seating Capacity	Balcony Level Seating Capacity	Stage Size (W x D)	Stage Proscenium Opening (W x H)	Main Floor Size	Ceiling
San Jose Civic	2,850 Reserved 3,322 GA	1,656 Reserved 2,128 GA	1,028 Reserved 1,500 GA	628 Total (Including 52 obstructed view seats)	1,194 Total (Including 90 obstructed view seats)	112' x 35'	49' 9" x 30'	79' x 118'	43'

SECOND & MEZZANINE LEVEL FLOOR PLAN

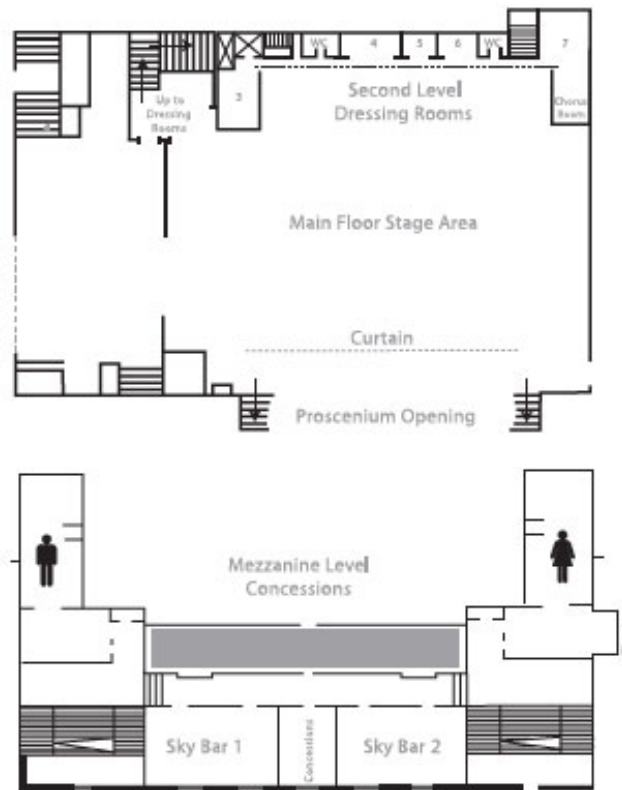

Location	Dimensions	Ceiling	Square Feet	Capacity (Theater Style)	Capacity (Banquet Style)	Capacity (Classroom Style)
Sky Bar 1	33' x 19'	11'	620	56	30	32
Sky Bar 2	33' x 19'	11'	620	56	30	32

Other Addresses and Phone Numbers

Taxi Companies	<i>Yellow Cab</i> www.yellowtaxicab.biz	(408) 561-7300	
Limo and Town car Service	<i>Service Plus Transportation</i> <i>Mr Jun Barron</i>	510- 408-7479 suv301@gmail.com	
Bus Services	VTA www.vta.org	(408) 321-2300	
Light Rail	The Convention Center light rail stop is a short walk from the San Jose Theaters. It is served by routes 901 (http://www.vta.org/routes/rt901) and 902 (http://www.vta.org/routes/rt902).		
Local Parking	Parking can be found at several nearby lots. Please visit https://sanjosetheaters.org/directions/ for information.		
Printing/Shipping	<i>FedEx Office Print & Ship Center</i> 93 E. San Carlos St. San Jose, CA 95112 (408) 295-4336	<i>The UPS Store</i> 88 S 3 rd St San Jose, CA 95113 408-293-9803	
Shopping	<i>Westfield Valley Fair Mall</i> 2855 Stevens Creek Blvd. Santa Clara Ca, 95050-6709 http://westfield.com/valleyfair/ (408) 248-4451	<i>Santana Row</i> 377 Santana Row San Jose, CA 95128 http://www.santanarow.com/ (408) 551-4611	
Restaurants	There are many fine restaurants within walking distance. Please visit https://www.sanjose.org/restaurants for more information.		
Restaurants <i>Open late</i>	<i>Original Joe's</i> 301 S. First St. San Jose, CA 95113 (408) 292-7030	<i>Loft Bar & Bistro</i> 90 S. 2 nd St. San Jose, CA 95113 (408) 291-0677	
	<i>Gordon Biersch</i> 33 E. San Fernando St. San Jose, CA 95113 (408) 294-6785	<i>Affinity (Hilton)</i> 300 Almaden Blvd. San Jose, CA 95113 (408) 287-2100	<i>Il Fornaio (Westin San Jose)</i> 302 S. Market St. San Jose, CA 95113 (408) 271-3366
Food Delivery	<i>Doordash.com</i>	<i>Grubhub.com</i>	
Coffee	<i>Starbucks</i> 125 S. Market St. San Jose, CA 95113 Closed weekends	<i>Caffe Frascati</i> 315 S. First St. San Jose, CA 95113 (408) 287-0400	<i>Peet's Coffee & Tea</i> 408 Almaden Blvd. San Jose, CA 95113 (hours vary)

Groceries	<i>Safeway</i> 1300 W. San Carlos St. San Jose, CA 95126 (408) 882-0999	<i>Whole Foods Market</i> 777 The Alameda San Jose, CA 95126 (408) 207-1126	
Laundromat	<i>Quickwash Laundry Inc.</i> 485 E. San Carlos St. San Jose, CA 95112 (408) 995-0895	<i>Keyes Laundromat & Pure Water</i> 454 Keyes St. San Jose, CA 95112 (408) 995-6992	
Post Office	<i>United States Postal Service</i> 105 N. First St. San Jose, CA 95113 (408) 292-0487		
Gyms	<i>Orange Theory</i> 111 W St John St #110 San Jose, CA 95113 (408) 912-2886		
Yoga	<i>Downtown Yoga Shala</i> 467 S. First St. San Jose, CA 95113 (408) 272-2631		
Banks			
#100	<i>Chase Bank</i> 55 W. Santa Clare St. San Jose, CA 95113 (408) 291-3331	<i>Bank of the West</i> 77 N Almaden Blvd San Jose, CA 95110 (408) 947-5005	<i>Union Bank</i> 99 Almaden Blvd San Jose, CA 95113 (408) 279-7700
	<i>Wells Fargo</i> 685 Coleman Ave #10 San Jose, CA 95110 408-660-3430	<i>Bank Of America ATM</i> 99 S 4th St San Jose, CA 95112	
Pharmacy	<i>Walgreens Drug Store</i> 1399 W San Carlos St San Jose, CA 95126 (408) 971-3098		
Doctors	<i>Ear, Nose and Throat</i> Dr. Hussein Samji 6060 Hellyer Ave. #150 San Jose, CA 95138 (408) 227-6300	<i>Dentist</i> Jonathan Yu DDS 2323 Forest Ave. San Jose, CA 95128 (408) 247-9626	<i>Chiropractor</i> Tina McGinnis, DC 5149 Moorpark Ave. #102 San Jose, CA 95129 (408) 253-9740