

SAN JOSE CIVIC

135 West San Carlos Street, San Jose, California 95113



FAST FACTS

- Located across the street from the *San Jose Convention Center*
- 2,850 maximum reserved seating capacity, with flexible seating configuration, including up to 137 ADA-Compliant seats
- 1,028 Main Floor seats
- 628 Dress Circle seats
- 1,194 Balcony seats
- 350 Banquet-Style seats
- 1,000 Classroom-Style seats
- Stage Size: 112' x 30'
- Stage Proscenium opening: 49'9" x 30'
- State-of-the-art sound and HD video systems
- Full staging and production capabilities
- Walking distance to surrounding hotels, restaurants, bars and nightlife

VENUE SYNOPSIS

The San Jose Civic received a \$15 million renovation, completed in 2012, that enhanced this historic venue with modern upgrades. These included new, customized seats, state-of-the-art sound and HD video systems, renovated and expanded restrooms, additional concession areas and a new three-story elevator.

The San Jose Civic partners with major promoters to host top tours. Since 2012, it has hosted such acts as David Byrne, Tony Bennett, Jason Bonham, Chicago, Taeyang, Luke Combs, David Blaine, Alice Cooper, NCT 127, Jackson Browne, Cheap Trick, J Balvin, Maluma, Greta Van Fleet, Bonnie Raitt, Tedeschi Trucks Band, Ringo Starr, Steely Dan, Il Divo, Styx and Sarah Brightman.

Built in 1934, the Civic has classic Spanish mission-style architecture. This designated City Landmark can accommodate a full range of events including corporate functions, galas and banquets. It can also be used in conjunction with the San Jose Convention Center, providing additional space for general assemblies, receptions, exhibits and meetings.

Located in the heart of Downtown San Jose, the San Jose Civic is within walking distance of hotels, bars, restaurants and museums. Public transportation is convenient, with stops for a free Downtown shuttle bus and Light Rail trains just steps away. Parking is close by at the Convention Center and additional lots.

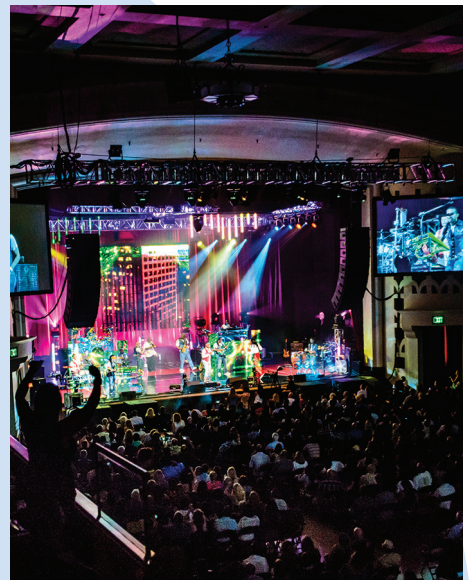

SAN JOSE THEATERS • SANJOSETHEATERS.ORG



MAIN LEVEL FLOOR PLAN

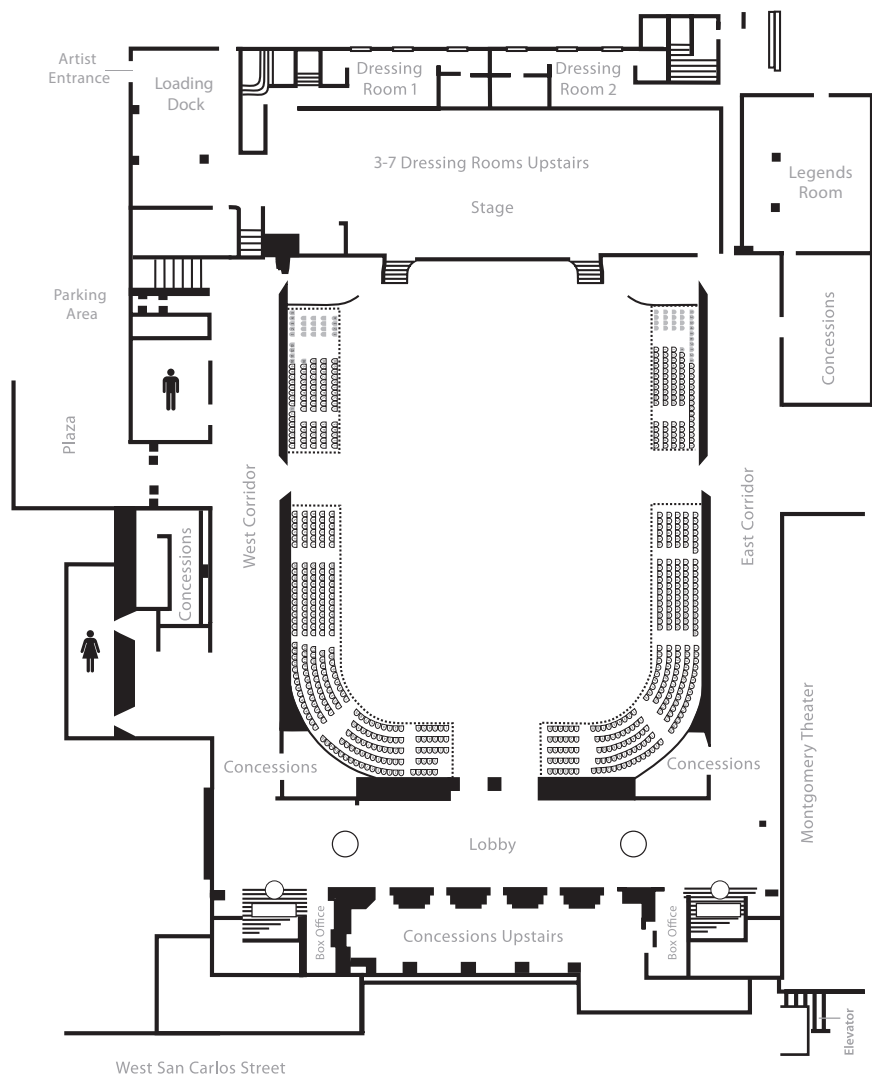

Location	Capacity	Main Level Capacity	Main Floor Section Seating Capacity	Dress Circle Section Seating Capacity	Balcony Level Seating Capacity	Stage Size (W x D)	Stage Proscenium Opening (W x H)	Main Floor Size	Ceiling
San Jose Civic	2,850 Reserved 3,322 GA	1,656 Reserved 2,128 GA	1,028 Reserved 1,500 GA	628 Total (including 52 obstructed view seats)	1,194 Total (including 90 obstructed view seats)	112' x 35'	49' 9" x 30'	79' x 118'	43'

MAIN LEVEL BANQUET SEATING PLAN

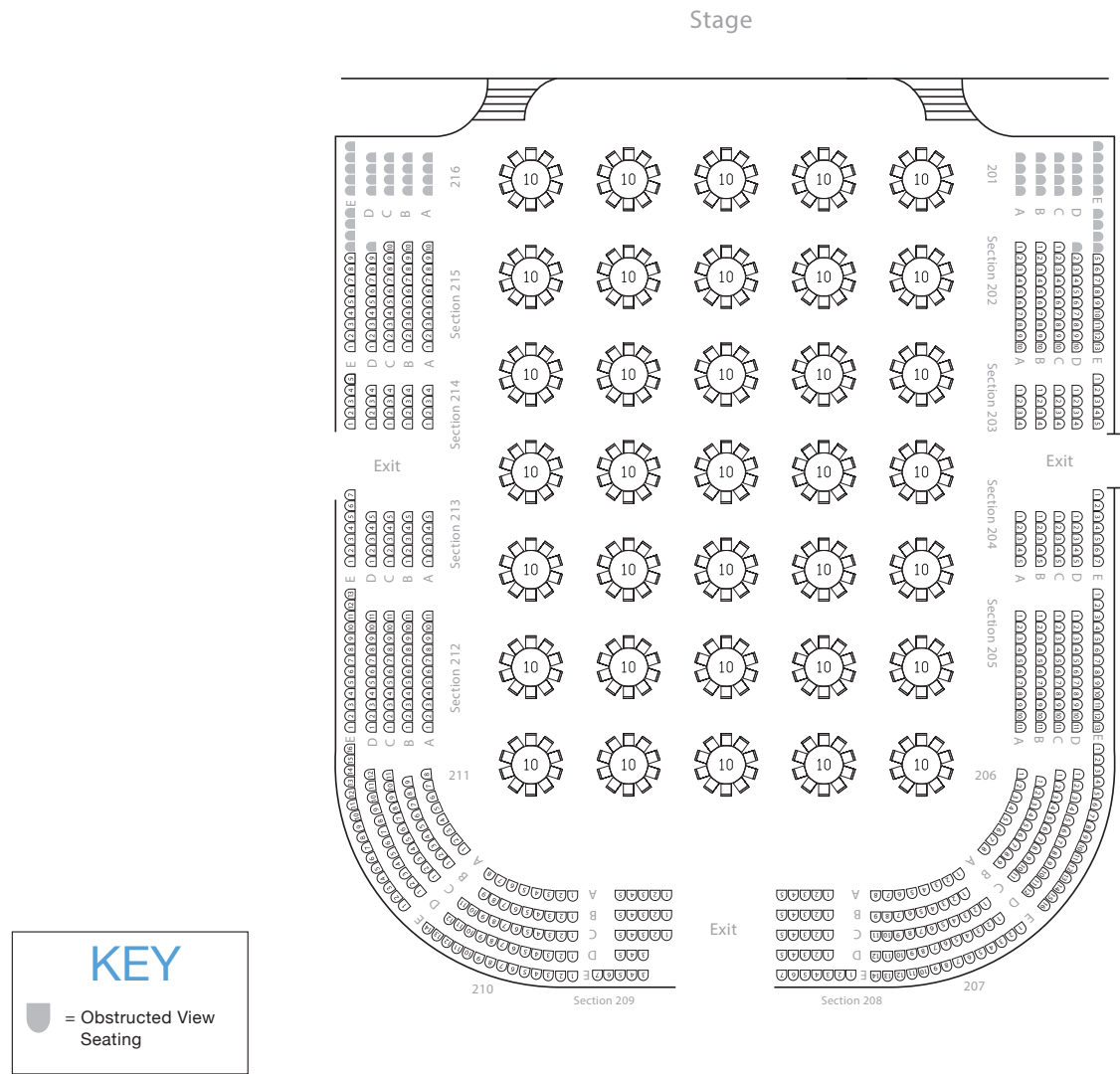

Location	Capacity	Main Level Capacity	Main Floor Section Seating Capacity	Dress Circle Section Seating Capacity	Balcony Level Seating Capacity	Stage Size (W x D)	Stage Proscenium Opening (W x H)	Main Floor Size	Ceiling
San Jose Civic	2,850 Reserved 3,322 GA	1,656 Reserved 2,128 GA	350 Banquet*	628 Total (including 52 obstructed view seats)	1,194 Total (including 90 obstructed view seats)	112' x 35'	49' 9" x 30'	79' x 118'	43'

*Seating setup and capacity subject to change

BALCONY LEVEL SEATING PLAN

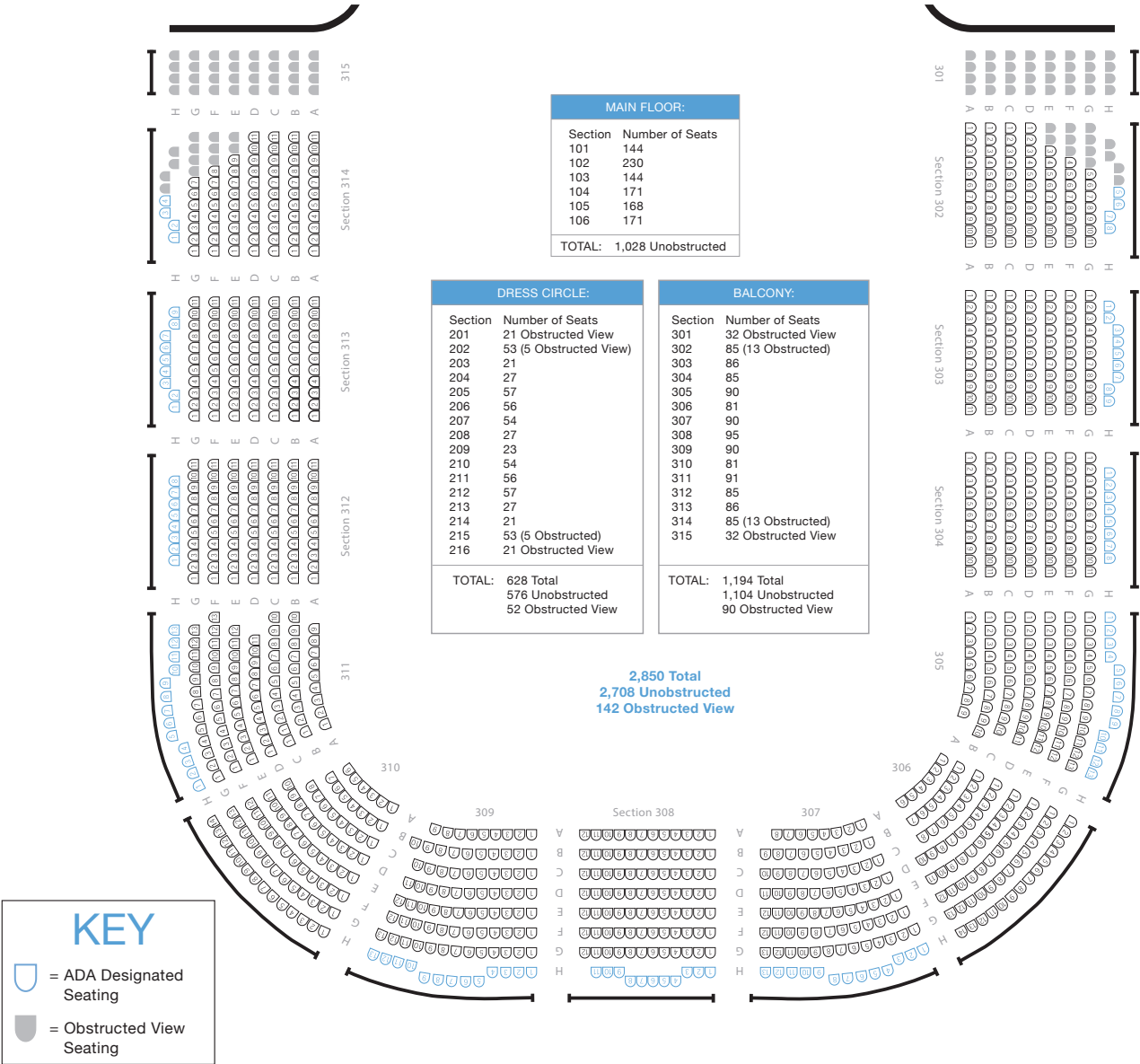

Location	Capacity	Main Level Capacity	Main Floor Section Seating Capacity	Dress Circle Section Seating Capacity	Balcony Level Seating Capacity	Stage Size (W x D)	Stage Proscenium Opening (W x H)	Main Floor Size	Ceiling
San Jose Civic	2,850 Reserved 3,322 GA	1,656 Reserved 2,128 GA	1,028 Reserved 1,500 GA	628 Total (including 52 obstructed view seats)	1,194 Total (including 90 obstructed view seats)	112' x 35'	49' 9" x 30'	79' x 118'	43'

SECOND & MEZZANINE LEVEL FLOOR PLAN

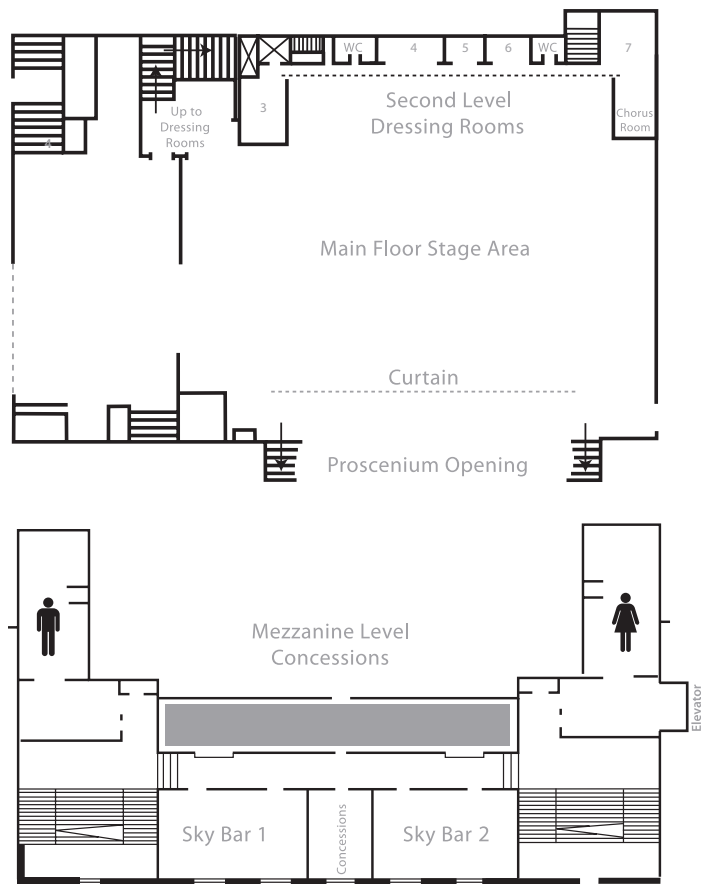

Location	Dimensions	Ceiling	Square Feet	Capacity (Theater Style)	Capacity (Banquet Style)	Capacity (Classroom Style)
Sky Bar 1	33' x 19'	11'	620	56	30	32
Sky Bar 2	33' x 19'	11'	620	56	30	32