

---

# Technical Specifications

---

Center for the  
Performing Arts



---

255 Almaden Blvd  
San Jose, CA 95113

---

## TABLE OF CONTENTS

<i>Overview</i>	3
<i>Fast Facts</i>	3
<i>Stage Dimensions</i>	4
<i>Load In</i>	4
<i>Stagehands</i>	5
<i>Stage Rigging</i>	5-7
<i>Curtains, Softgoods, Masking and Miscellaneous</i>	8
<i>Apron</i>	8
<i>Lighting</i>	8-10
<i>Power</i>	10
<i>Sound</i>	10
<i>Additional Spaces</i>	11-12
<i>House Seating Capacities</i>	12
<i>Pianos</i>	12
<i>Odds and Ends</i>	12
<i>Calipers</i>	12
<i>Seating Plan</i>	13
<i>Floor Plan</i>	14
<i>Other Addresses and Phone Numbers</i>	15-16



## Overview

The San Jose Center for the Performing Arts, designed by the Frank Lloyd Wright Foundation and completed in 1972, sits just across the street from the Convention Center. If your meeting calls for a show or presentation, the beautiful, comfortable and flexible Center for the Performing Arts is your ticket. Complete with full-service box office, concessions and top-notch audio visual capabilities, the Center offers dual level, continental-style auditorium seating (no center aisle) with a capacity of up to 2,608.

## Fast Facts

- Built in 1972 by the Frank Lloyd Wright Foundation
- Large windows throughout entryways filled with natural light, allowing spectacular views of downtown San Jose
- Continental-style auditorium seating (no center aisles)
- Full service Box Office
- Ample spacing throughout entry areas for cocktail receptions or registration space
- Private Ridder Lounge equipped with built in concessions/bar area
  - Capacity for 150
  - Perfect for VIP reception, press/media room for events, or a post-event reception
  - Adjacent to outdoor courtyard
  - Access to backstage dressing rooms
- Private President's Club equipped with built in concessions/bar area
  - Capacity for 50
  - Perfect for VIP reception, press/media room for events, or a post-event reception
  - Adjacent to main entrance with access to backstage
- Home to Broadway San Jose

## Stage Dimensions

- Proscenium Width 59' 6"
- Proscenium Height 34' 0"
- Grid Height 68'
- CL to Stage Right Wall 71' 11" (69' 2" to fly lines)
- Stage Left Wall to Stage Right Wall 143' 5"
- CL to Stage Right Wall 71' 10"
- PL to House Curtain 0' 10" (this is line set #1)
- PL to US Wall (at CL) 44' 0"
- PL to FOH Control Room 124' 0"

## Load In

The Loading Dock is located down a sloping, serpentine ramp, with entrances on Almaden Boulevard and San Carlos Boulevard. The largest truck that can fit down this ramp is one (1) 45' box with a snub nose tractor and a sliding rear axle. Anything larger must be unloaded at street level and then forked or pushed down the ramp and then either forked onto the dock or pushed up a truck ramp.

The ramp is 18' wide and the rollup door on the dock (+3' -6") is 13' wide by 10' high. Access to the stage from the dock is through a 10' x 10' double door. With a policeman on duty to block traffic you can stage two 53' trailers on the Almaden Boulevard side of the ramp allowing for two trucks to be tipped simultaneously. We suggest using a forklift at the top of the ramp for each trailer to offload road boxes and carts, pushers to push down the ramp and a second forklift and/or truck ramp at the dock to get the equipment into the building. You may also want to arrange for a flatbed tow truck to be utilized for extremely heavy loads (i.e. service trusses). Experience dictates this method being the safest and most efficient way of loading into the theater.

At times, it has also been advantageous to rent two 24' box trucks and transfer loads to drive to the loading dock as an alternate option.



## Stagehands

General Guideline of Rates and Conditions:

- Class A is entertainment including plays, dances, circuses, fund raisers, concerts and fairs. There are three separate type labor calls for a Class A events. Load In for which there is a 4 hour minimum. Performance Call which commences 30 minutes prior to curtain and ends 3.5 hours after curtain or you shall be billed (on the hour) for OT; this is a flat rate. Load Out is a 4 hour minimum or 3 hours if one worked the show call.
- Class E is corporate, corporate parties, commercial and industrial events, trade shows, computer generated presentations, as well as audio and/or video recording, where the product is to be sold to the attendees or the general public. Any event, including Class A events, where an audio and/or video signal is broadcast outside the room from which it originates, and/or said event is recorded for future broadcast or commercial distribution, will be considered a Class E event. For Broadcast, Webcast and Simulcast rates, see Exhibit A. 8 Hour minimums for everyone but loaders who have 5 hour minimums.
- There shall be a buyout fee associated with events for broadcast, webcast, simulcast, or other commercial distribution in the amount of 8 hours regular time for everyone on the call during the actual event Class A or Class E.
- Stagehands break for 15 minutes after 2 continuous hours worked and break for meal after 5 hours worked. Work on stage shall cease for 1 hour during non-paid one hour meal breaks. 30 minute meal breaks shall be paid and the stage hands shall have their meal provided for them by the client. Meal penalty is two times the prevailing rate. Returning from a 1 hour meal break a stagehand receives a 2 hour minimum.
- Work between the hours of Midnight and 7am shall be paid at double time.
- There shall be department heads for Sound, Electrics, Video, and Carpentry. The steward is above the call. Standard union rules apply.

## Stage Rigging

The Grid Height is 68'. All Single Purchase Line-sets can be flown out to 68' 0" or with Motorized Line-sets to 66' 0".

### *Single Purchase Line-sets*

There are 39 single purchase counterweight line-sets, between 0' 10" to 32' 2" from PL. Each arbor has a 1,050 pound capacity. The locking rails (or control of) these line-sets are stage right (above stage level). All of these battens are 63' in length and standard system pipe construction (Sch40 1½ pipe).

### *Motorized Line-sets*

The theater also has 16 motorized line-sets: 4 variable speed motors (3.1 fps max speed) and 12 constant speed motors (1.24 fps fixed speed), between 24' 10" and 39' 9" from PL. The load limit is 750 pounds. Control of the winch lines requires an operator (typically the local Head Carpenter) on the control panel, which is located on the deck DSR. Each of these winch lines are 68' in length and are a ladder truss construction.

### *Motorized Electric Bridges*

There are two Electric Bridges (ME1 & ME4 on the Hang Plot) that are hard-wired with folding conduit trays to power the bridges. These two bridges are controlled from the deck (DSR) and travel very slowly. These bridges can fly out to clear 58' 0" floor.

LINE		DEPTH	PIPE TO PIPE	PIECE	TRIM	WT	NOTES
PL		0' 0"	0"	PLASTER LINE			
FC		0' 3"	3"	FIRE CURTAIN			
MC		0' 10"	7"	HOUSE MAIN DRAPE			
1		1' 3"	5"	HSE BORDER			
2		1' 10"	7"	HSE LEGS			
3		2' 5 1/2"	7"				
4		2' 11 1/2"	7"				
5		3' 5"	6 1/2"				
ME1	unkickable	3' 7"	2"	1ST ELECTRIC BRIDGE			39 hard-wired circuits, loft block at 4' 2"
		5' 3"	8				
6		5' 11 1/2"	8 1/2"				
7		6' 6 1/2"	7"				
8		7' 2"	7 1/2"				
9		7' 9 1/2"	7"				
10		8' 1"	5 1/2"	HSE BORDER			
11		8' 10"	9"	HSE TRAVELER			
12		9' 6 1/2 "	8 1/2"				
13		10' 3 "	6 1/2 "				
14		10' 10 1/2"	7 1/2"				
15		11' 9 1/2 "	11"	2ND ELECTRIC			24 drop circuits
16	unkickable	12' 7"	9 1/2"				
17	unkickable	13' 3 1/2"	8 1/2 "				
18	unkickable	13' 9"	5 1/2"				
19		14' 3 "	6"				
20		15' 5"	14"	HSE BORDER			
21		16' 3 "	10"	HSE LEGS			
22		16' 9"	6"				
23		17' 4 1/2"	7 1/2"				
24		17' 11 1/2"	7"				
25		18' 9"	9 1/2"	3RD ELECTRIC			24 drop circuits
26		19' 7"	10"				
27		20' 1 1/2"	6 1/2"				
28		20' 9 1/2"	8"				
29		21' 2 "	4 1/2"				
30		21' 9"	7"	HSE BORDER			
31		22' 3 1/2"	6 1/2"	HSE LEGS			
32		22' 10"	6 1/2"				
33		23' 4 1/2"	6 1/2"				
34		23' 10"	5 1/2"				
35		24' 4"	6"				
W1	V	24' 10 1/2"	6 1/2"				
W2	V	25' 7 1/2"	9"				
ME2	F	26' 6 "	10 1/2"				

	F	28' 0"	S	4TH ELECTRIC BRIDGE			31 hard wired circuits, loft block at 27' 6"
36		28' 5"	5"				
37		29' 4 ½"	11 ½"				
W3	V	29' 7"	2 ½"	HSE BORDER			
38		30' 0"	5"				
W4	V	30' 10 ½"	10 ½"	HSE LEGS			
39		31' 5"	6 ½"				
40		32' 3 ½"	10 ½"				
W5	C	33' 0"	8 ½"				
W6	C	33' 8 ½"	8 ½"				
W7	C	34' 6"	9 ½"				
W8	C	35' 0"	6"				
W9	C	35' 6"	6"				
W10	C	36' ½"	6 ½"				
W11	C	36' 7 ½"	7"				
W12	C	37' 0"	4 ½"				
W13	C	37' 9 ½"	9 ½"	HSE BORDER			
W14	C	38' 4"	6 ½"	HSE LEGS			
W15	C	39' 3"	11"				
W16	C	39' 9"	6"	BACK BLACKS			
V=Variable Speed Motors							
C=Constant Speed Motors							
F=Fixed Position (non-kickable)							

There is a hemp rail stage left and right (above stage level). It is a 2-level type with 39 pins per level. Team San Jose has over 60 spotting wheels and 30+ spotting lines at the theater for your usage.

#### Over Stage Rigging Points

Tem San Jose has an ample amount of grid logs (3" Sch40 pipe 36" long) stored up in the grid. The grid is a standard C-channel grid.

#### FOH Rigging Points

Speaker and Lighting Towers: There are two points located 4' 0" DS of PL and 28' 3" SR & SL of CL. These points are rated for 1500# max each point. These two points can ONLY be hung motor down.

## Curtains, Soft Goods, Masking and Miscellaneous

6 full width black borders with chain pockets (60' W x 16' H)  
6 pairs of black legs with chain pockets (16' W x 32' H)  
1 full black backdrop (60' W x 30' H)  
1 black traveler normally hangs on line-set 11 (2 panels 30' W x 32' H)  
1 bleached muslin seamless 60' W x 30' H white cyclorama

### *Main Curtain*

Guillotine, works from fly rail. Curtain is burgundy with gold trim.

## Apron Area

With the pit elevators down at house level (or below), the apron of the stage has a concave shape, which is narrowest at CL (4' 10½") and gets wider as you move off stage (9' 7").

Dimensions: From PL to US edge of orchestra pit is 4' 10½" at center. From PL to DS edge of orchestra pit is 22' 5 ½". The Orchestra Lift is "eye" shaped, 17' 7" at center (upstage/downstage) by 58' 3" (left to right).

## Lighting

Followspots are \$150/day or \$350/week.

We have 4 Lycian 1295 ELT 3kW

### Lighting Fixture Daily Rates:

1 to 39 - \$950,  
40 to 60 - \$1100,  
61 to 120 - \$1500,  
121 to 230 - \$2500

ETC Gio 2K

ETC Sensor-AF Dimmers

### Instruments:

54 Source4 575W 10°  
101 Source4 575W 19°  
96 Source4 575W 26°  
40 Source4 575W 36°  
18 7inch Fresnel 2k  
140 Par64 1k  
8 Colortran FarCyc 3win 2kW  
14 Ministrip 3col 750W

Lighting Position	Throw to Curtain	
1st Beam	53'	70
2nd Beam	65'	65
Box Booms	80'	60-20
Balcony Rail	80'	28
Spot Booths	125'	45



## Lighting Equipment Inventory

CONSOLES		CHANNELS	DIMMER ADDRESSES	SOFTWARE
ETC	INSIGHT 2X	512	1536	v3.03
ETC	OBSESSION	1536	1536	v2.4.2

DIMMERS	ETC SENSOR-AF NUMBER	LOAD
STAGE	618 12	2.4KW 6KW
HOUSE	6 6	2.4KW 12KW

### FIXTURES

NUMBER	LOCATION	MAKE	TYPE	BEAM	LOAD	FRAME
34	2 BEAM	ETC	SOURCE 4	10*	575	12X12"
10	BOOM BOX SL	ETC	SOURCE 4	10*	575	12X12"
10	BOOM BOX SR	ETC	SOURCE 4	10*	575	12X12"
24	1 BEAM	ETC	SOURCE 4	19*	575	6X6"
4	BALCONY RAIL	L&E	PAR 64	NARROW	1KW	10X10"
PORTABLE						
77		ETC	SOURCE 4	19*	575	6X6"
76		ETC	SOURCE 4	26*	575	6X6"
20		ETC	SOURCE 4	36*	575	6X6"
18		ALTMAN	7" FRESNEL		2KW	9" RND
136		ALTMAN/ L&E	PAR 64	ASSORTED	1KW	10X10"
6		COLORTRAN	FAR CYC	3/WIN	2KW	14.5X15"
6		COLORTRAN	FAR CYC	1/WIN	2KW	14.5X15"
14		L&E	MINISTRIP	3/COL	750W	3X4.5"

WE ALSO	HAVE TEN 6'	TREES	EACH HAS			
20		ETC	SOURCE 4	26*	575	6X6"
20		ETC	SOURCE 4	36*	575	6X6"
4	LYCIAN	1290 LONG THROW XENON			2KW	

FOH SPECS.

POSITION	THROW TO CURTAIN	ANGLE IN DEGREES
1 <sup>ST</sup> BEAM	53'	70
2 <sup>ND</sup> BEAM	65'	66
BOX BOOMS	60'	60-20
BALCONY RAIL	80'	28
SPOT BOOTHS	125'	45

## Power

Power 3-400 Amp 3Ø  
 1400 Amp 3 phase total  
 Power all camlock or bare tails  
 Lighting 3-400 Amp 3Ø DSL  
 Sound 1-200 Amp 3Ø (Isolated) DSL  
 Power 3-400 Amp 3Ø Cam Lock or bare tails tie in isolated power  
 1-200 Amp 3Ø Power

## Sound

7 - JBL 4888DP Line Array for each Left, Right, and Center.  
 6 JBL 4882DP Subs  
 2 JBL AM 6212 Wide Fills  
 4 JBL AM 6212 Balcony Under Fills  
 Console is a PM5D With Dual PW800 Power Supplies.  
 Soundweb 9088 Processing  
 Rental is \$1000/1 day, \$1500/2 days, \$2000/3-5days

There is only one 10" tube 105' long running from stage to the back of house. 225' snake will reach from SL and 175' from SR.

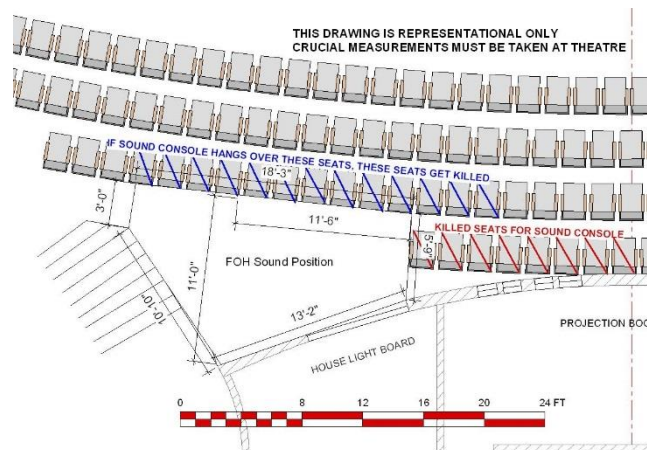
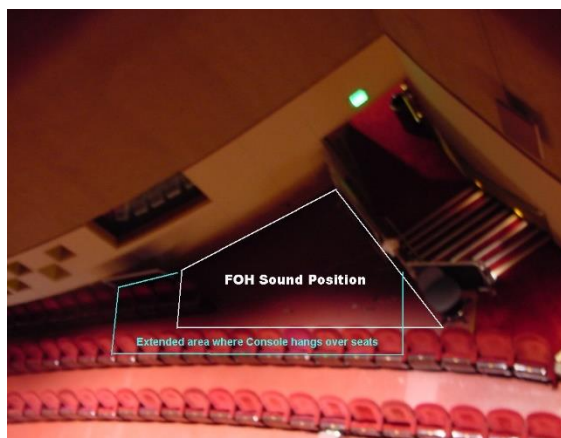

## Additional Spaces

### *Dressing Rooms*

All dressing rooms are one level above stage level and are accessible by stairways both stage left and stage right. Each is fully equipped with showers, sinks, toilets and make-up tables with lights and chairs. There are also two quick-change rooms on stage level, through a door off-stage right. See drawings for layout.

Dressing Room #1	Principal Room (carpeted and sofa) only for 1 person
Dressing Rooms #2, 3 & 4	Principal Room (no carpet) for 2-4 people, but most comfortable with only 2 people
Dressing Rooms #5 & 6	Principal room (no carpet) for 2 people, but most comfortable with only 1 person
Dressing Room #7	Men's chorus room; can accommodate up to 30 (would be a tight fit)
Dressing Room #8	Women's chorus room; can accommodate up to 25 (would be a tight fit)

<u>Dressing Room</u>	<u>Dimensions</u>	<u>Amenities</u>
<i>Stage Level</i>		
Quick Change 1*	8'6" x 6'	Dry
Quick Change 2	8'6" x 6'	Dry
Actor's Lounge*	20' x 23'2"	Dry (Production Office)
<i>One Level Above Stage</i>		
Dressing Room 1	13'5" x 24'6"	Sink, Toilet, Shower
Dressing Room 2	12'11" x 10'5"	Sink, Toilet, Shower
Dressing Room 3	14'8" x 10'3"	Sink, Toilet, Shower
Dressing Room 4	17'2" x 8'7"	Sink, Toilet, Shower
Dressing Room 5	8'4" x 8'8"	Sink, Toilet, Shower
Dressing Room 6	7'9" x 8'7"	Sink, Toilet, Shower
Wig Room	16'1" x 19'6"	Toilet, Urinal, 2 Shower Stalls, 3 Sinks Five 20 Amp Circuits and Portable Makeup Stations
Men's Chorus*	24' x 28'	2 Toilets, 4 Urinals, 5 Shower Stalls, 7 Sinks, 34 Mirror Stations
Women's Chorus*	42' x 14'	6 Toilets, 5 Shower Stalls, 8 Sinks, 34 Mirror Stations
Laundry Room	27'10" x 14'8"	3 Top Loading Washers, 3 Driers, 1 Slop Sink
<i>One Level Below Stage</i>		
Rehearsal Hall*	45' x 50'	Same Dimensions as the interior of the orchestra shell on stage.
(RH) Dance Floor	44' x 37'	Marley dance floor size inside of Rehearsal hall
Conductors DR	10' x 5'	1 Toilet, 1 Sink, 1 Shower Stall, 1 Mirror Station
Musicians DR	27'11" x 24'2"	Woman's Room, 3 Toilets, 3 Sinks; Men's 1 Toilet 1 Urinal, 3 Sinks
The pit is accessed from this level while the pit is in normal performance position.		

\*Size approximate due to irregular shape. Below diagram is one level above stage.



## House Seating Capacities

- 2,608 seating capacity
  - 1,852 Orchestra seats (Includes 20 ADA spaces)
  - 756 Balcony seats

## Pianos

The theater owns an older 9' Steinway grand piano and an upright rehearsal piano.

## Odds & Ends

Theater has a 36' genie personnel lift.

There are various TV monitors around the building, which carry a closed circuit of the stage, but there is not one on the stage or at the stage manager's panel.

## Calipers

There are two acoustic sound baffles (called Calipers) located down-stage left and right, 7' 9" down-stage of the plaster line, which when turned parallel with the house walls contributes to the acoustic accuracy of the hall. They can also be rotated to be parallel to the plaster line and act as an additional wing. They are 36' tall and 12' wide. On their off-stage side there is a standard door, which is four or five steps to another door directly to the stage.

There are light ladders and vertical bars affixed to the upstage side of the Calipers to serve as additional lighting "box boom" type positions.

# SEATING PLAN

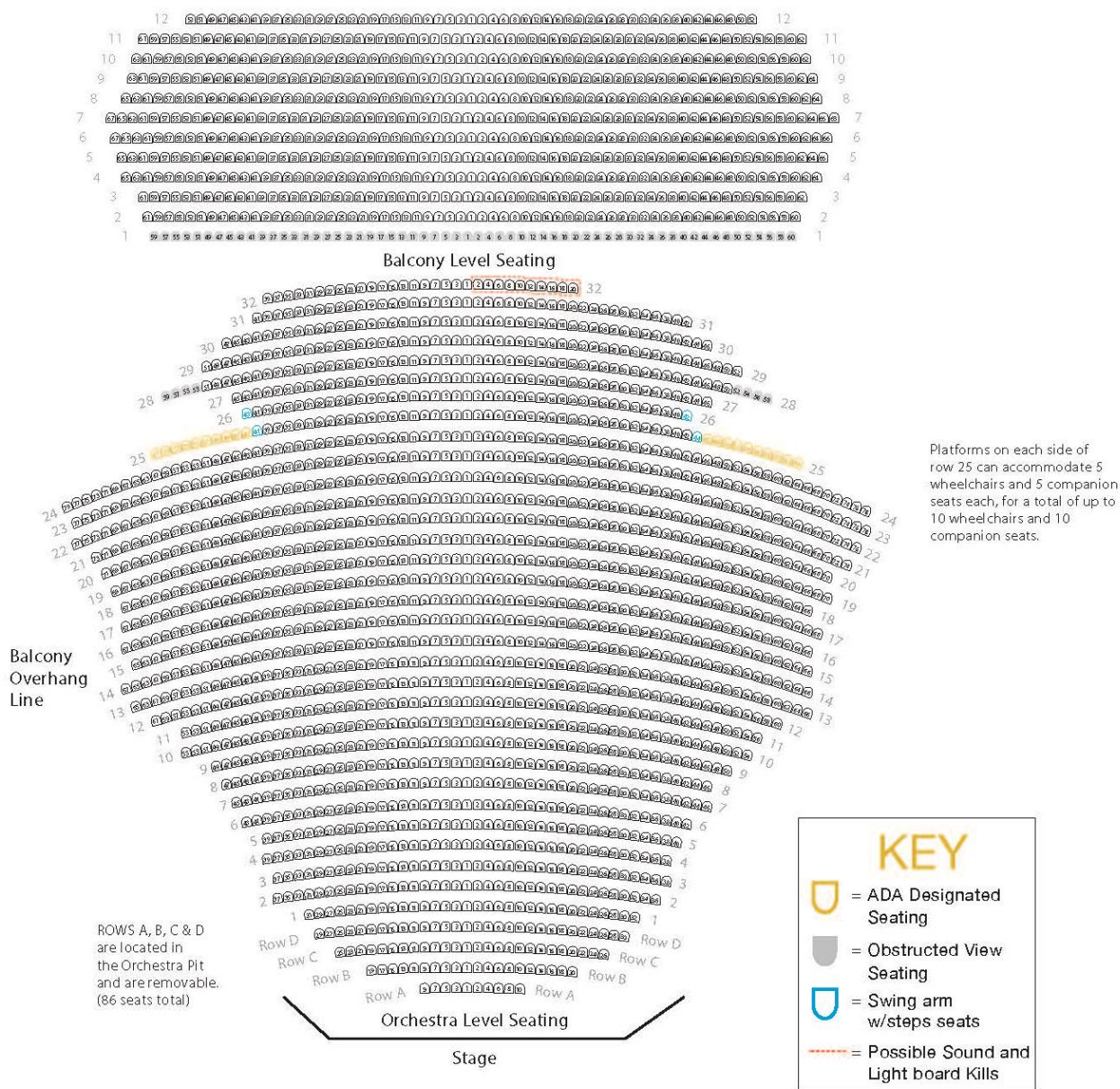

Location	Capacity	Orchestra Level Seating Capacity	Balcony Level Seating Capacity	Stage Proscenium Opening (W x H)	Stage Size (W x D)
Center for the Performing Arts	2,608	1,852 Total (Includes 20 ADA spaces)	756 Fixed	59' 6" x 34'	144' x 40'





## FLOOR PLAN

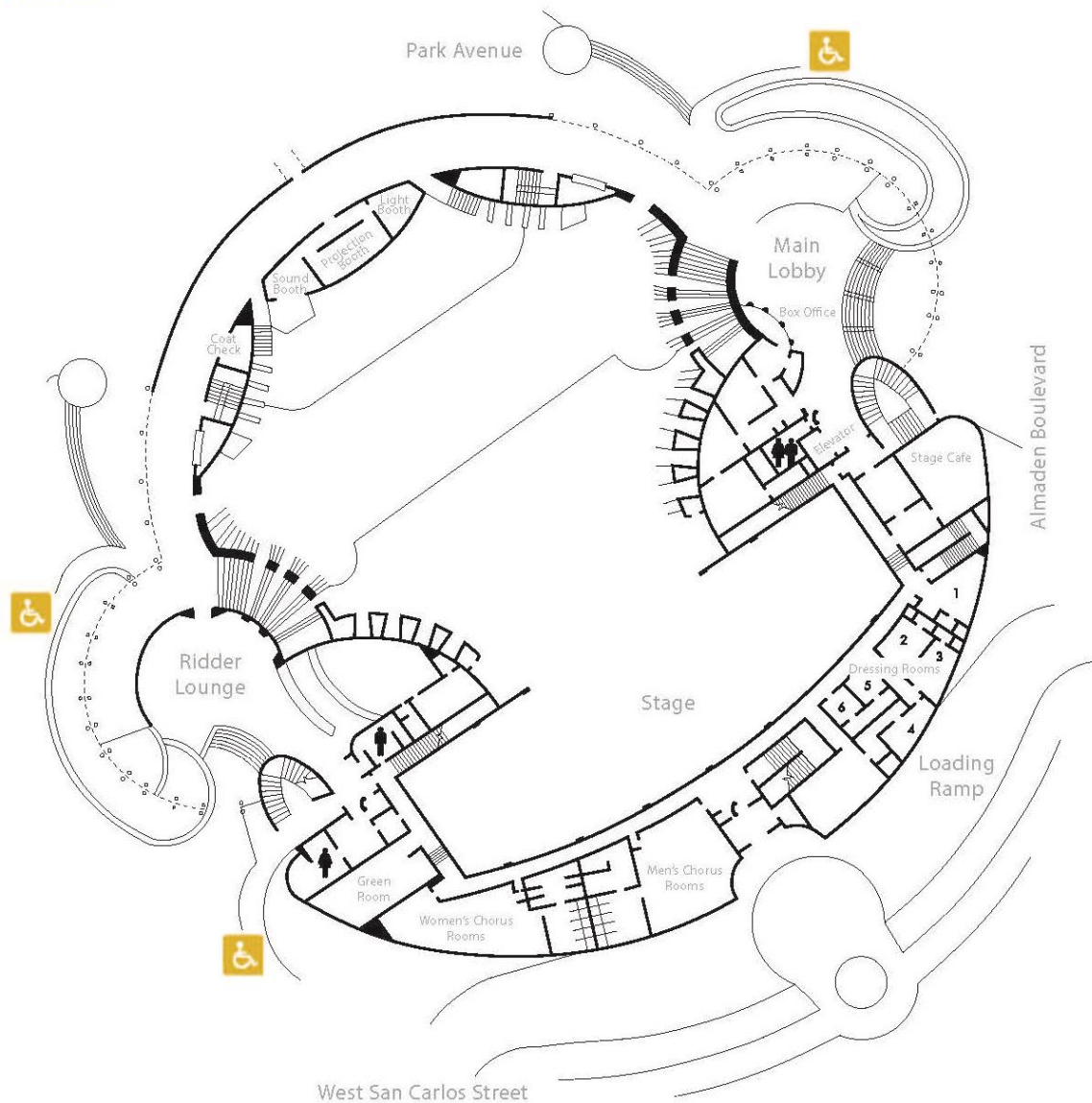

Location	Capacity	Orchestra Level Seating Capacity	Balcony Level Seating Capacity	Stage Proscenium Opening (W x H)	Stage Size (W x D)
Center for the Performing Arts	2,608	1,852 Total (Includes 20 ADA spaces)	756 Fixed	59' 6" x 34'	144' x 40'

## Other Addresses and Phone Numbers

Limo & Towncar Service	Bauer's Transportation Direct: (415) 522-1212		
Taxi Companies	Rainbow Cab (408) 271-9900 <a href="http://www.rainbowtaxicab.com">www.rainbowtaxicab.com</a>		
	Yellow Tax Co Inc. CA (408) 771-3155 <a href="http://www.allstaryellowcab.com">www.allstaryellowcab.com</a> (408) 437-6000		
Bus Services	VTA (408) 321-2300 <a href="http://www.vta.org">www.vta.org</a>		
Lightrail Stop Map/Info	<a href="http://www.vta.org/schedules/schedules_bymap.html">http://www.vta.org/schedules/schedules_bymap.html</a>		
Local Parking	The Center for the Performing Arts is located in downtown San Jose, where parking can be found at a number of lots. Please visit the following link for parking rates and information: <a href="http://www.sanjose.org/content/downtown-san-jose-parking-and-maps">http://www.sanjose.org/content/downtown-san-jose-parking-and-maps</a>		
FedEx Kinko's	93 E San Carlos St	(408) 295-4336	
Shopping	Valley Fair Mall (408) 248-4451 2855 Stevens Creek Blvd. Santa Clara Ca, 95050-6709 <a href="http://westfield.com/valleyfair/">http://westfield.com/valleyfair/</a>		
Movie Theaters	Camera 12 (408) 998-3300 201 South Second Street		
	Camera 3 (408) 294-3334 288 Second Street		
Restaurants	There are many fine restaurants within walking distance. The site below is for SanJose.com, and gives a comprehensive list of restaurants, their address, type of cuisine offered, as well as links to maps: <a href="http://www.sanjose.org/plan-a-visit/dining-nightlife">http://www.sanjose.org/plan-a-visit/dining-nightlife</a>		
Restaurants Open After 10pm	Original Joe's 301 S. First Street (408) 292-7030	Henry's Hi-Life 301 West St. John St (408) 295-5414	La Pastaia (Hotel DeAnza) 233 W. Santa Clara St. (408) 297-6785
	Gordon Biersch 22 E. San Fernando St. (408) 297-6785	City Bar & Grill (Hilton) 300 Almaden Blvd (408) 947-4444	Il Fornaio (Hotel St. Claire) 302 S. Market St. (408) 271-3366
Food Delivery	Hanuman Thai Cuisine	Godzilla Sushi Express	Papa John's



	1 East San Fernando St. San Jose, CA 95113 (408) 286-2482	130 E. Santa Clara St. San Jose, CA 95113 (408) 297-0568	1360 The Alameda San Jose, CA 95126 (408) 879-0202
Coffee	Starbucks 150 S. First St.	Cafe Trieste 315 S. First St.	Red Berry Café 231 E. Santa Clara St.
Groceries	Zanotto's 38 S. Second St (408) 997-1333	Safeway 1300 W. San Carlos (408) 882-0999	
Laundromat	Spincycle Laundromat 994 First St. San Jose, CA 95110	(408) 885-0993	
	Diamond Laundromat 398 W. San Carlos San Jose, CA 95110	(408) 295-3223	
	Wash America 330 E. Santa Clara St San Jose, CA 95113	(408) 998-2218	
Post Office	200 S. Third Street	(408) 292-0487	
	Main Branch: 1750 Lundy Ave	(800) 275-8777	
Gyms	Bally Total Fitness 150 S. First St. (408) 924-4000	Club One, Santana Row 3055 Olin Ave, Suite 3000 (408) 985-5555	
Yoga	Soula Power Yoga 200 S. First Suite 70 (408) 993-9642	Downtown Yoga Shala 450 S. First St. (408) 885-1000	